



EC1

DERINDER

HARD AND SEMI-HARD CHEESES



PRESENTATION

A suction system ensures the cheese remains in place on the plate, without damaging it. The arm can quickly and simply be fitted with interchangeable peeling and scraping tools. The cheese is automatically rotated when the arm is moved towards the cheese.

The rotation speed is variable depending on the type of cheese. Arm construction allows the top and side of the cheese to be worked on in a single operation.

TECHNICAL INFORMATION

The values shown below are indicative only and can be adapted to the customers specific needs.

DESIGN ALTERNATIVES

1. Standard version

Standard use with cheeses up to 50 kg

2. Reinforced version

For larger, heavier cheeses, up to 110 kg

3. Lifting plate version

For integration in a semi-automatic or automatic derinding line

WEIGHT

Approximate masse 260 kg–290 kg
Depending on models (1-3) and options

ELECTRICITY

Rated voltage (tolerance ± 5%)	3x400 Vac 3LNPE
Rated current	16 A
Assigned frequency	50 Hz
Maximum power	1.5 kW
Building residual current circuit breaker FI (DDR)	30 mA, type B, HI
Upstream overload cut-off	16 A/C

OPERATIONAL FEATURES

Number of operators	1
Suction strength (to hold the cheese in place)	- 0.6 bar
Plate rotation speed	0 – 100 rpm
Machine only, no-load reading (at operator location, no extraction)	60dB(A)
Loss at rind removal (Depends on the knife depth and cheese appearance)	
- Gruyère scraping (min.)	2 %
- Gruyère rind removal (min.)	5 %

PRODUCTS FEATURES

Extreme values may require specific accessories such as plates and heighteners to be added.

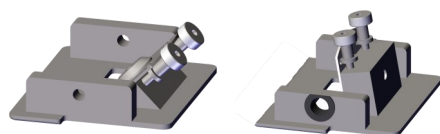
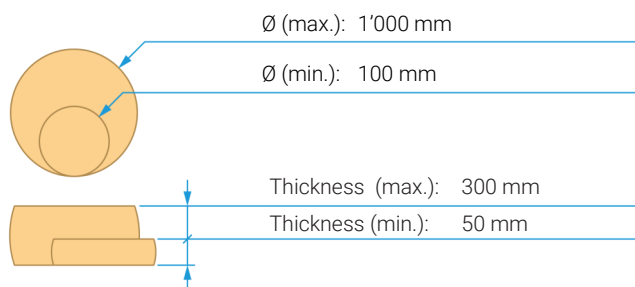

Derinder	Scraper
30°	80°
45°	

STANDARD EQUIPMENT

- Three-phase plug type 15 or Euro (export: without plug)
- 10 m power cable

OPTIONS

- Suction plate, various diameters
- Arm extension for taller cheeses
- Additional derinding and scraping tools
- System allowing to reduce the rotational speed of the plate while being used
- Suction system (separate product data sheet)
- Turn-over assistance, with and without centring

DIMENSIONS

Measures in mm

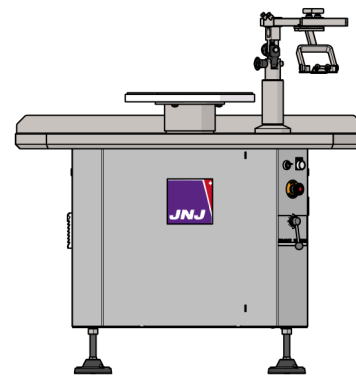

⚙ = Height adjustment
+/- (100 mm)

